

Courses & Distances
down the Creek, from the
Alder above to the Hemlock Below

N 36 W	37 prs
N 87 W	38 prs.
S 76 W	90 prs.
S 52 W	51 ps.
South	<u>20 ps. to the Hemlock</u>
	236

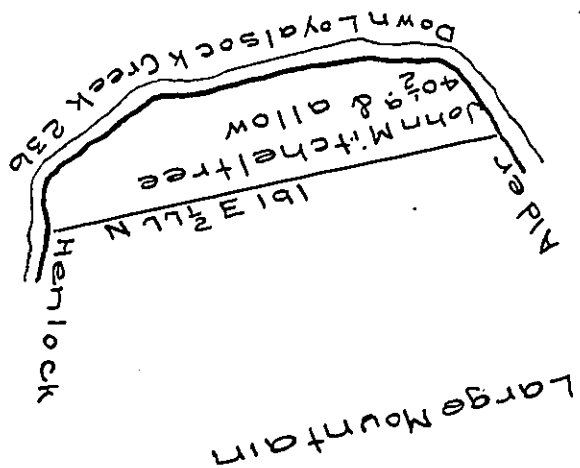

Draught of a tract of land situate on Loyalsock Creek a few miles above the Narrows in the County of Northumberland surveyed on the first day of September 1792 for John Mitchell tree in pursuance of his warrant for 400 acres bearing date the first day of July 1784 Containing Forty acres and one half with the allowance of six per cent for roads &c.

To Dan! Brodhead Esquire
Surveyor General

Jo. J. Wallis D.S.

IN TESTIMONY that the above is a copy of the original remaining on file in the Department of Internal Affairs of Pennsylvania, made conformably to an Act of Assembly approved the 16th day of February, 1833, I have hereunto set my Hand and caused the Seal of said Department to be affixed at Harrisburg, this twenty-third day of November 1905

Isaac D. Brown
Secretary of Internal Affairs.